

REVISJONS		DATE	BY	REASON

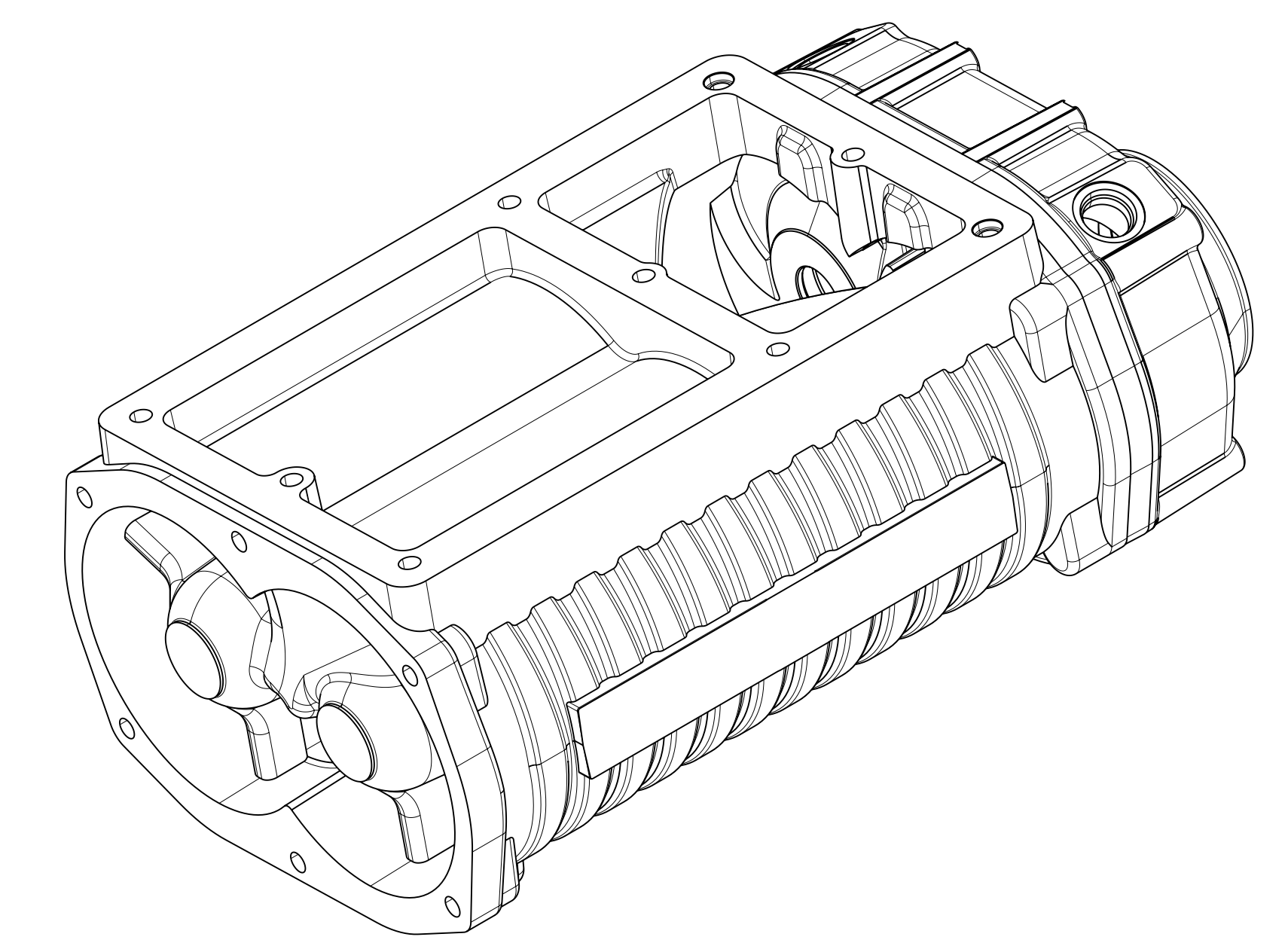
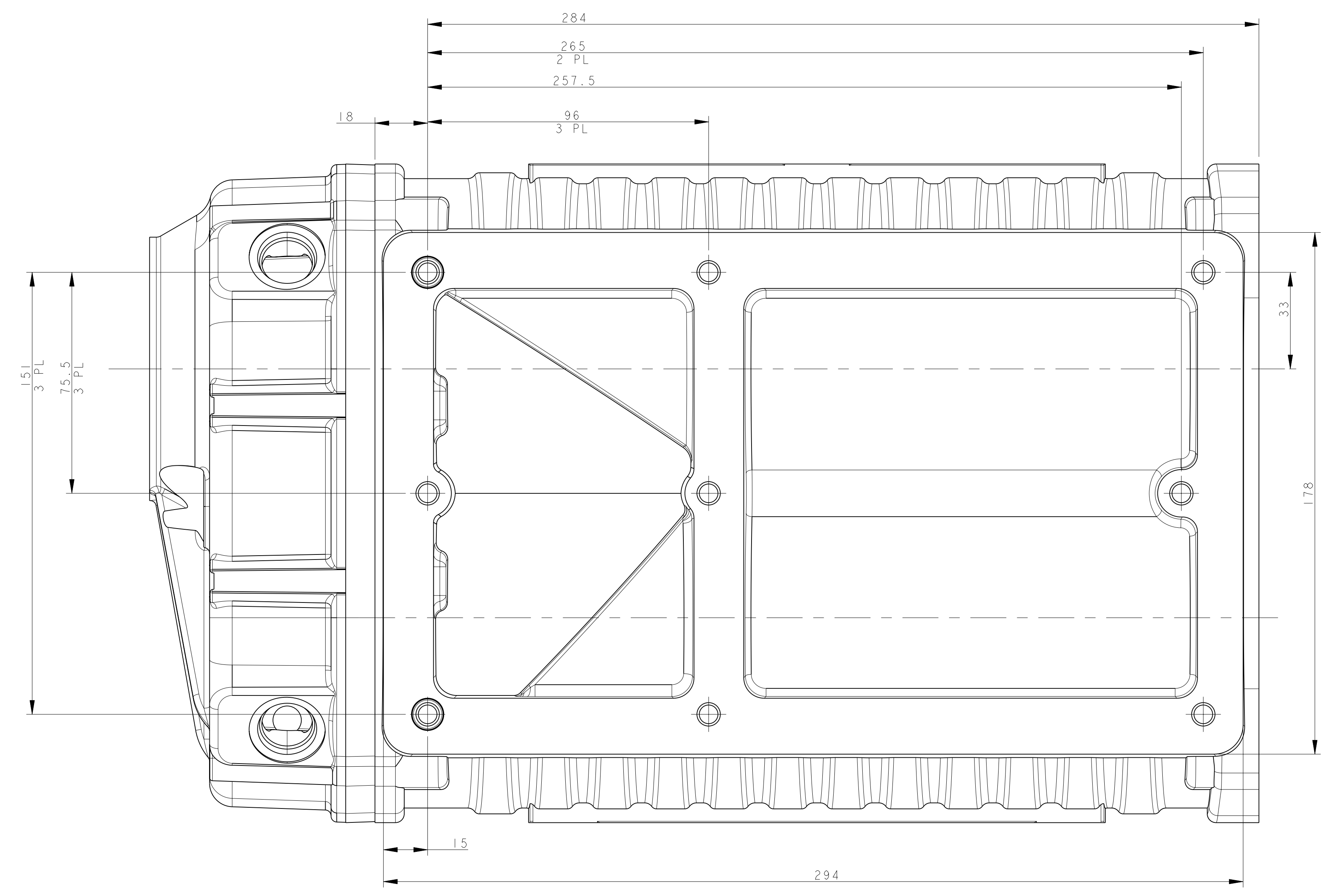
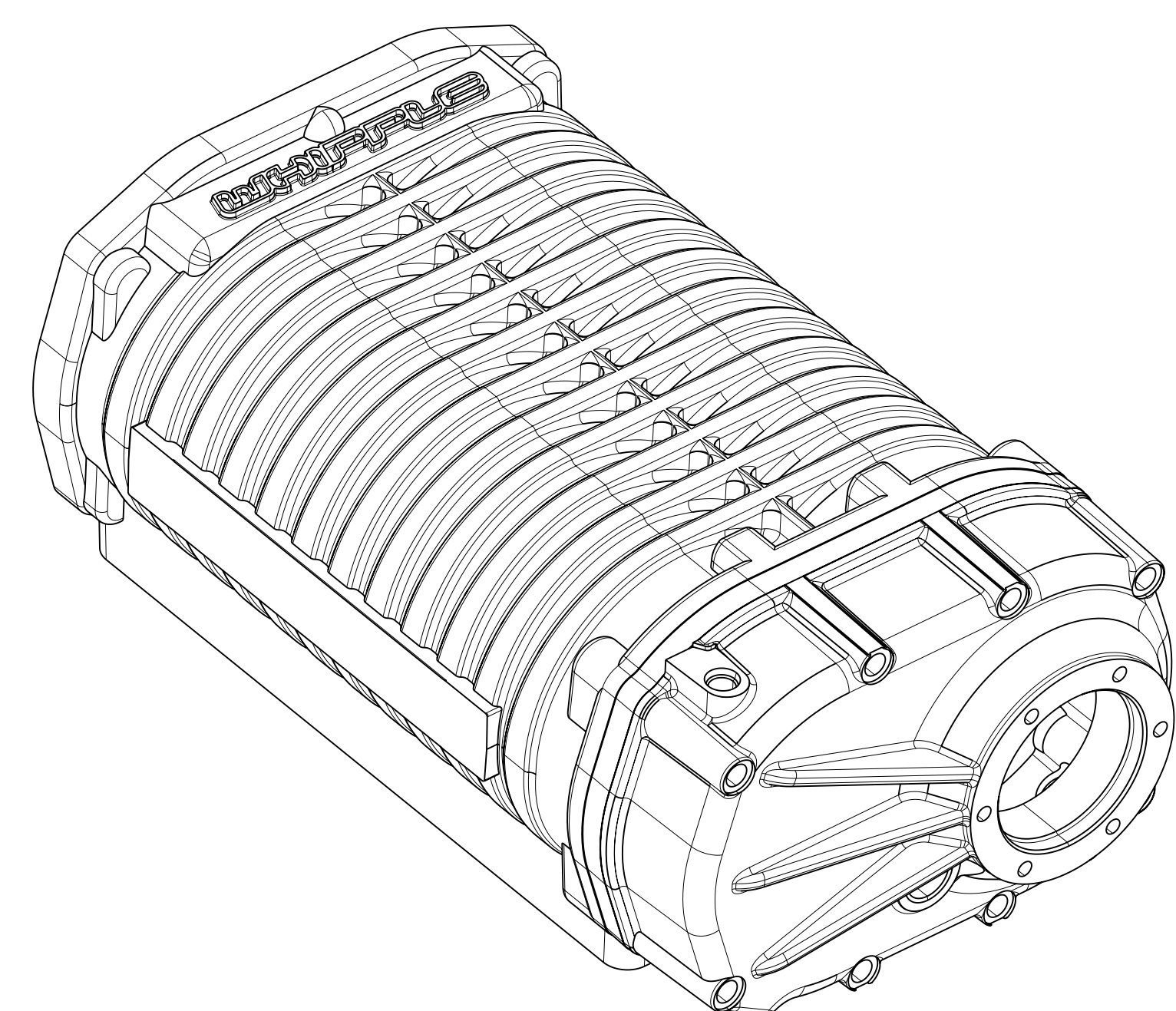
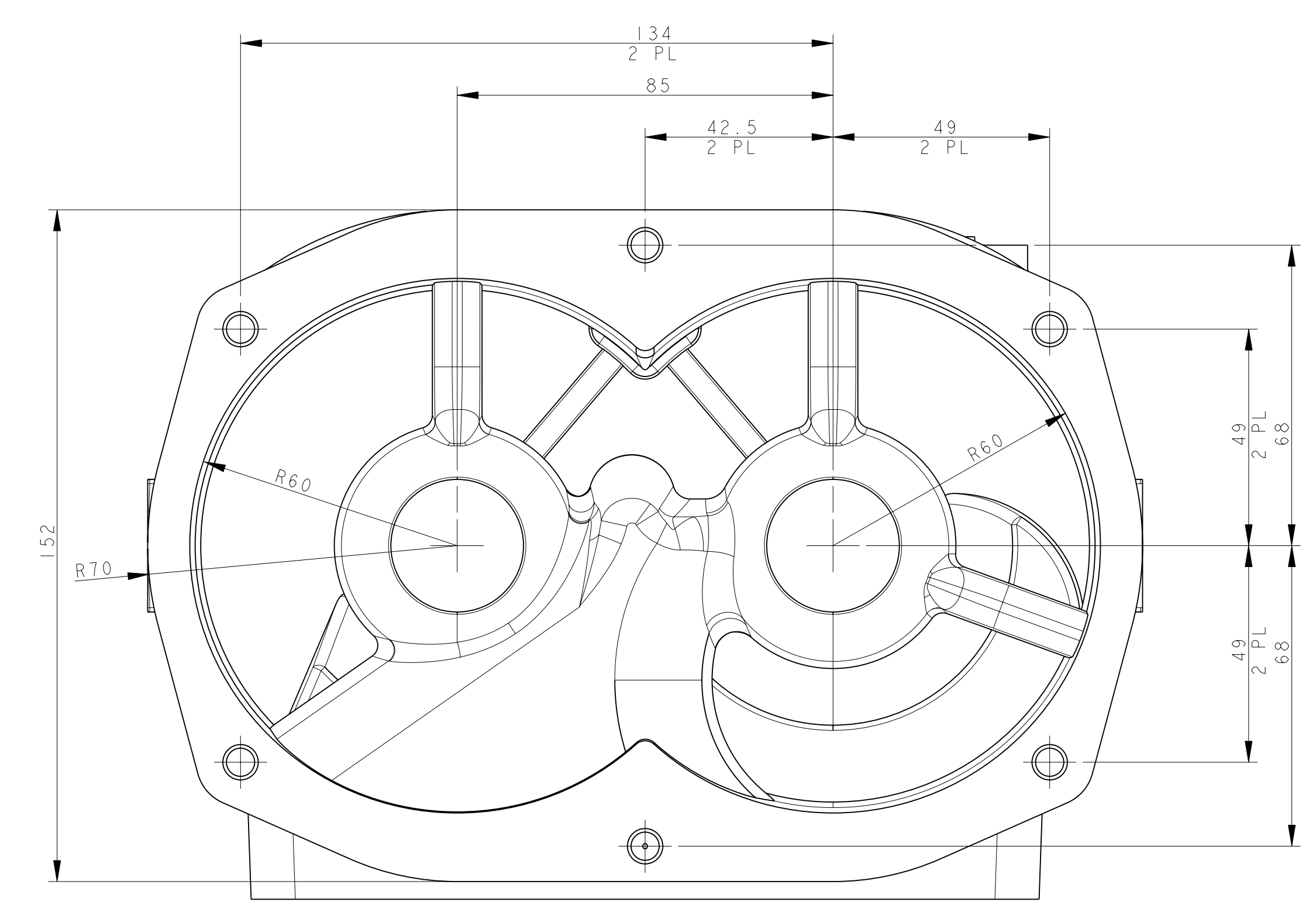
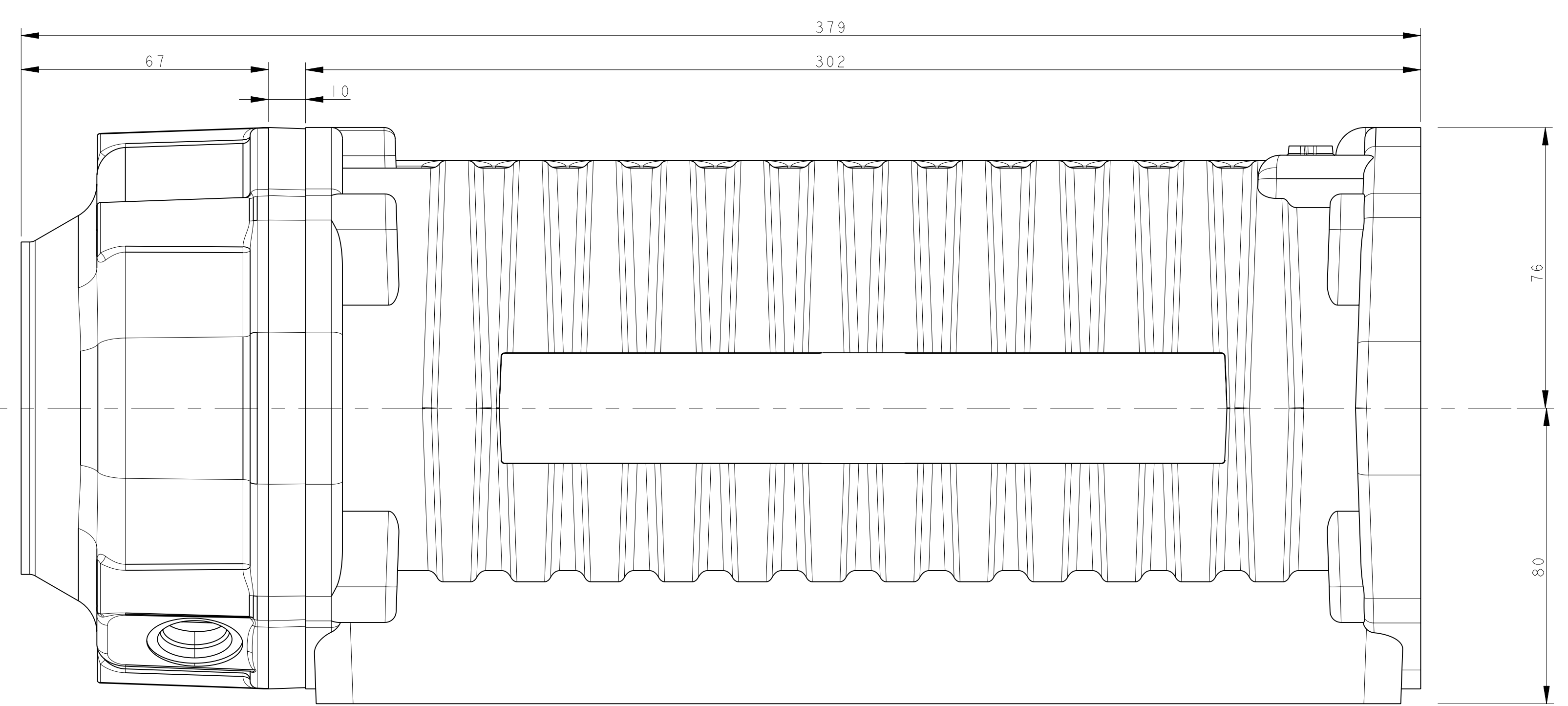
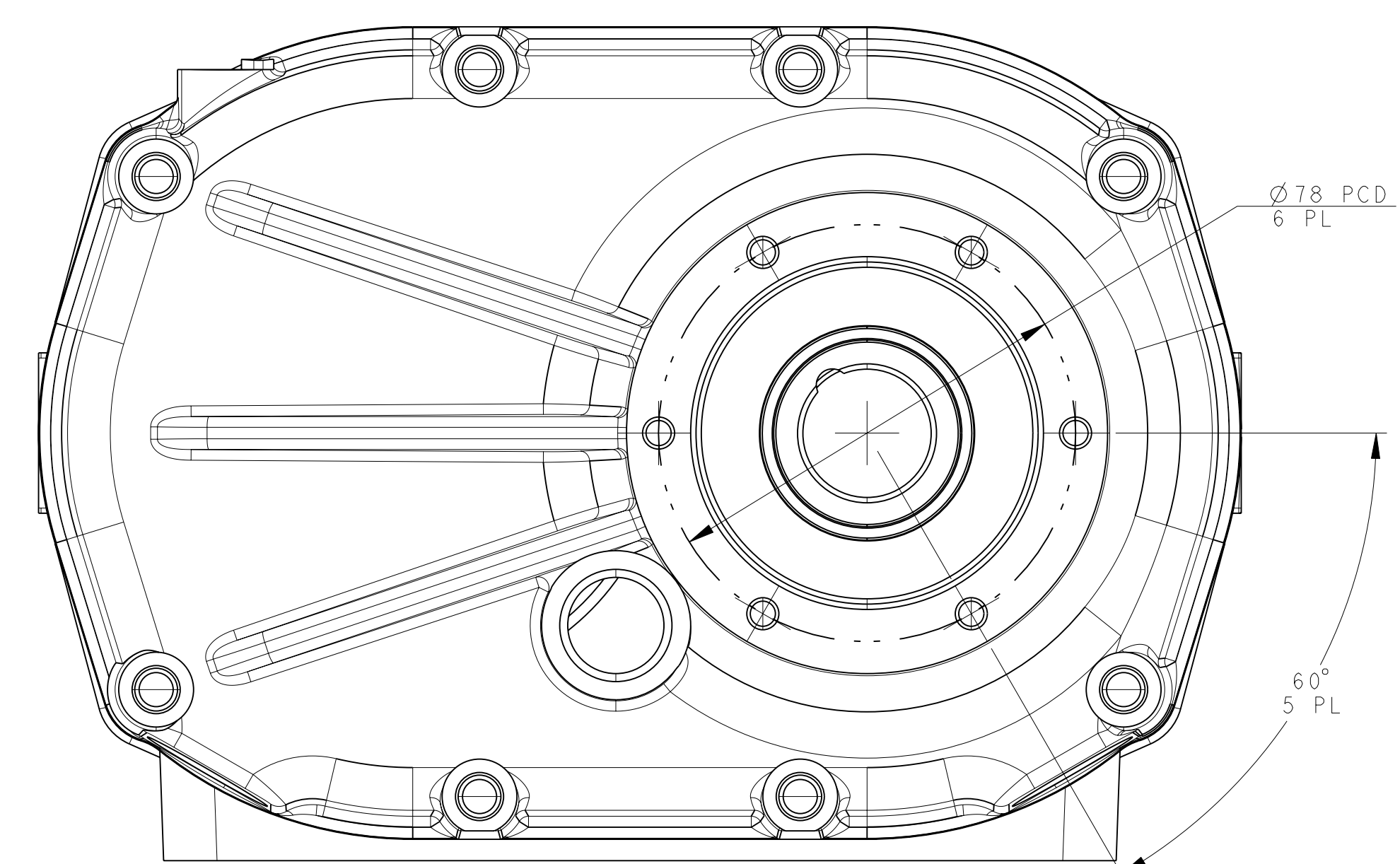
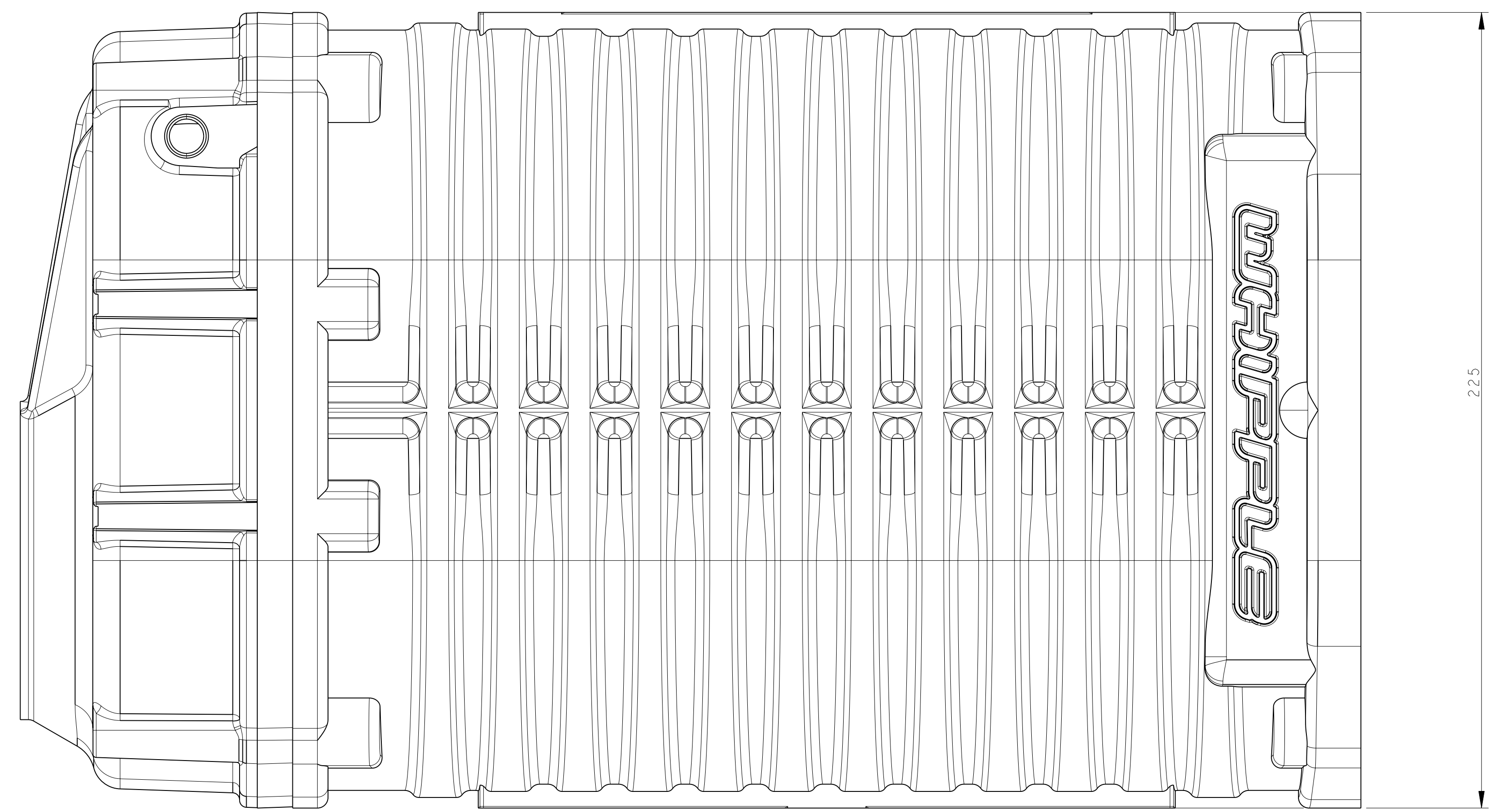

SURFACE FINISH (µm)		TOLERANCE		FINISH		TOLERANCE		TOLERANCE		TOLERANCE		TOLERANCE		TOLERANCE	
Rz	12.5	0.1	0.05	0.05	0.05	0.05	0.05	0.05	0.05	0.05	0.05	0.05	0.05	0.05	0.05
Rz	12.5	0.1	0.05	0.05	0.05	0.05	0.05	0.05	0.05	0.05	0.05	0.05	0.05	0.05	0.05

THIRD ANGLE PROJECTION

UNLESS OTHERWISE SPECIFIED:
 1. DIMENSIONS ARE IN MILLIMETERS.
 2. DECIMAL DIMENSIONS APPLY AFTER FINISHING.
 3. DIMENSIONS APPLY AFTER FINISHING.
 4. DIMENSIONS ARE IN MILLIMETERS.

OPEN TOLERANCES:
 + 0.05mm - 0.05mm R 0.1
 + 0.10mm - 0.10mm R 0.15
 + 0.15mm - 0.15mm R 0.2
 + 0.20mm - 0.20mm R 0.25
 + 0.25mm - 0.25mm R 0.3
 + 0.30mm - 0.30mm R 0.35
 + 0.35mm - 0.35mm R 0.4
 + 0.40mm - 0.40mm R 0.45
 + 0.45mm - 0.45mm R 0.5
 + 0.50mm - 0.50mm R 0.55
 + 0.55mm - 0.55mm R 0.6
 + 0.60mm - 0.60mm R 0.65
 + 0.65mm - 0.65mm R 0.7
 + 0.70mm - 0.70mm R 0.75
 + 0.75mm - 0.75mm R 0.8
 + 0.80mm - 0.80mm R 0.85
 + 0.85mm - 0.85mm R 0.9
 + 0.90mm - 0.90mm R 0.95
 + 0.95mm - 0.95mm R 1.0

SURFACE PREPARATION:
 AFTER SURFACE PREPARATION:
 NONE
 LAZER MECHANICAL
 METAL TAG, STICKER
 PLASTIC BAG

MATERIAL:
 ALUMINUM
 6061-T6

TREATMENT:
 NONE

DATE: 07/26/08
DATE: 07/26/08
DATE: 07/26/08
DATE: 07/26/08

SCALE: 1:0
SHEET: 1 OF 1

TITLE: SUPERCHARGER_W200AX
WHIPPLE SUPERCHARGERS

DRAWING NO.: WHIPPLE_W200AX
SCALE: 1:0
SHEET: 1 OF 1