

REV. NO.		REVISIONS		DATE	

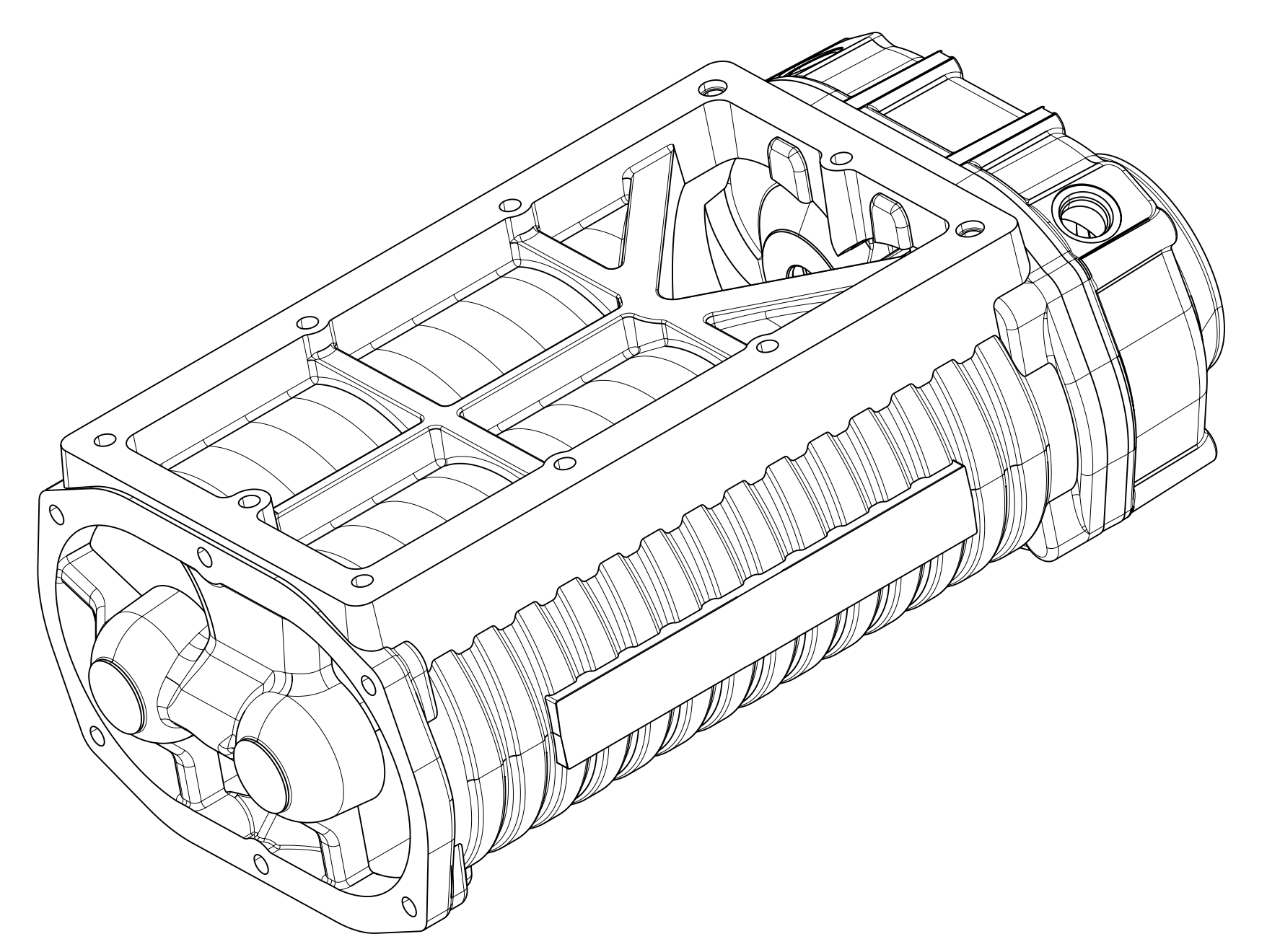
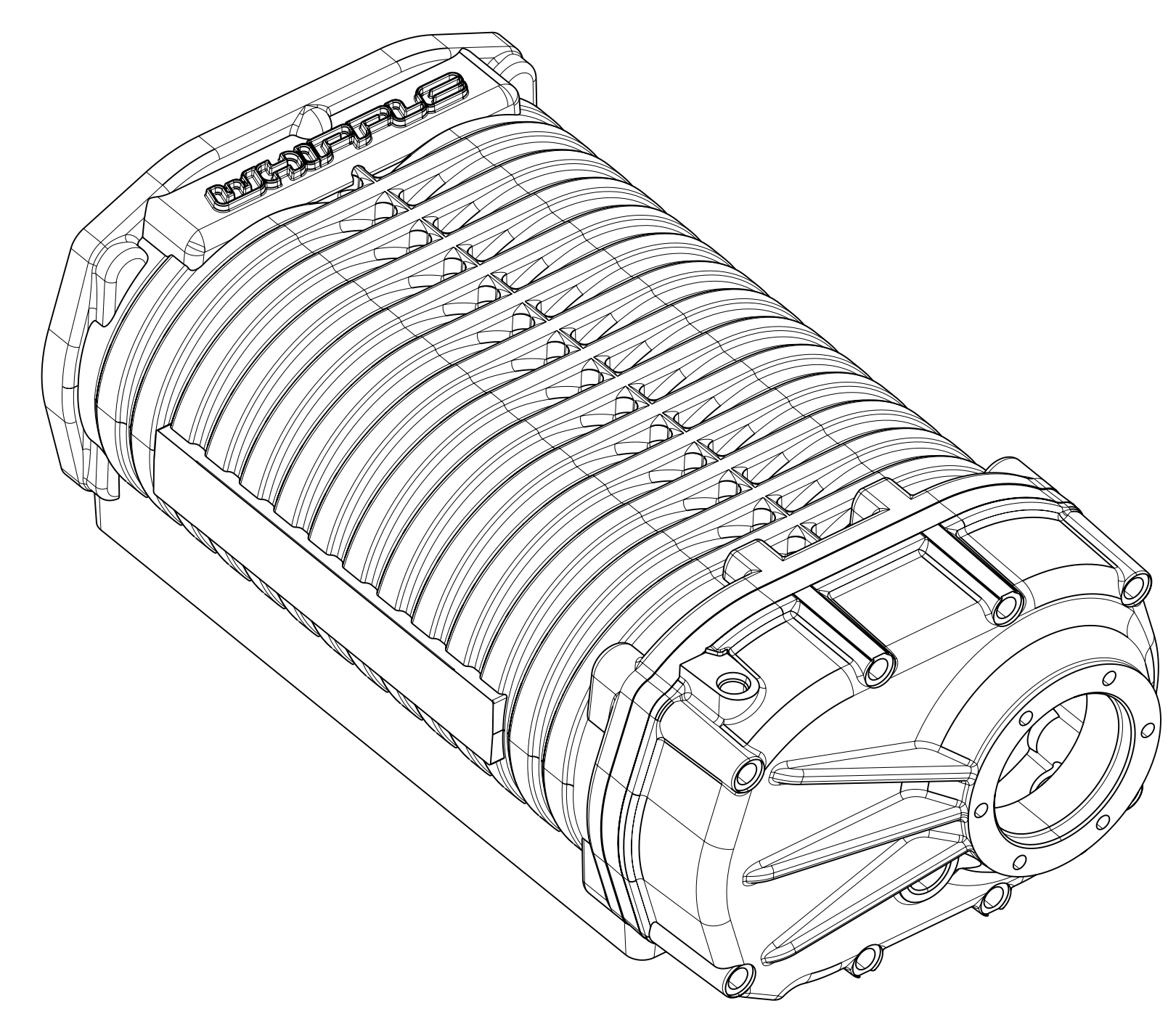
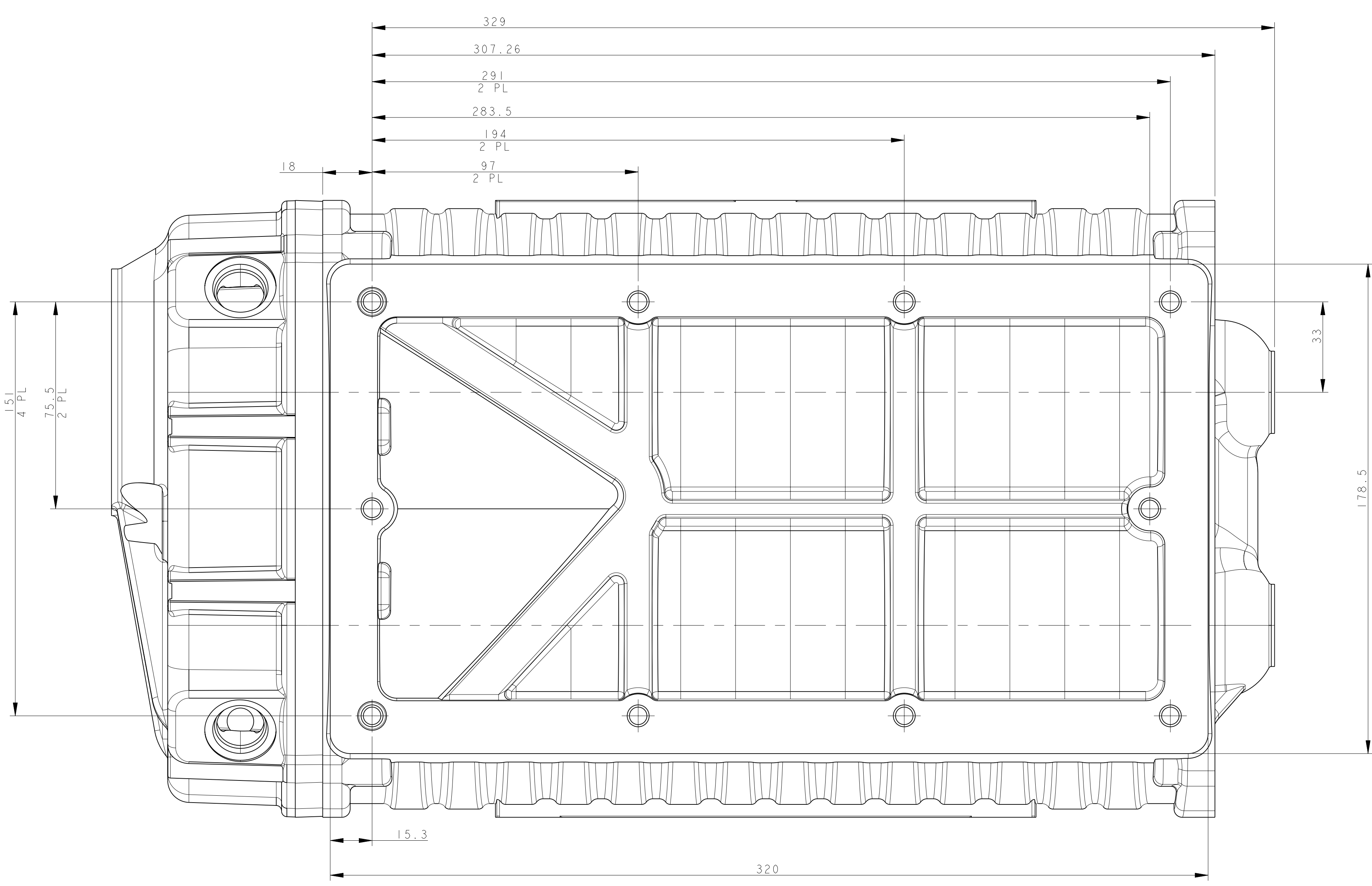
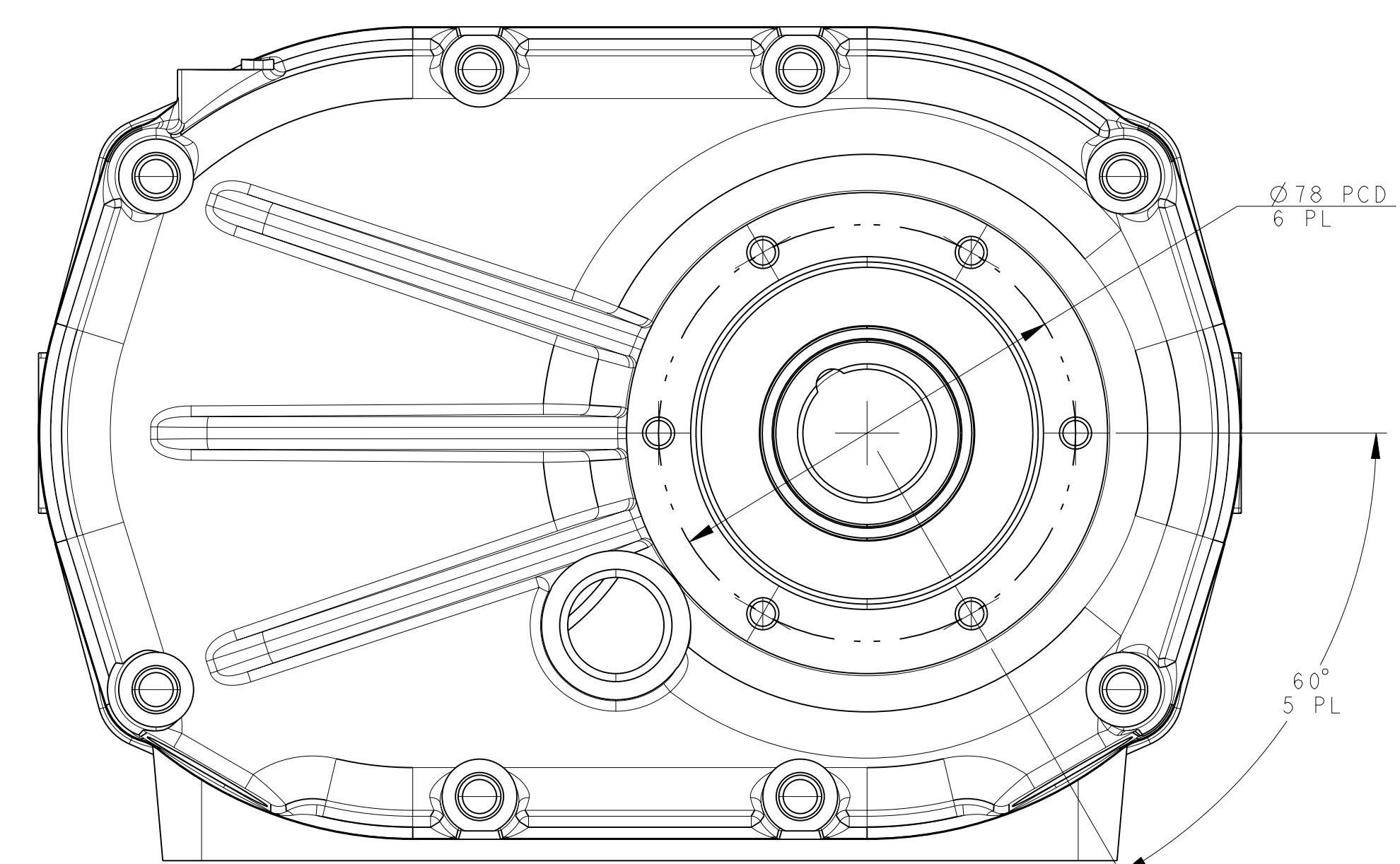
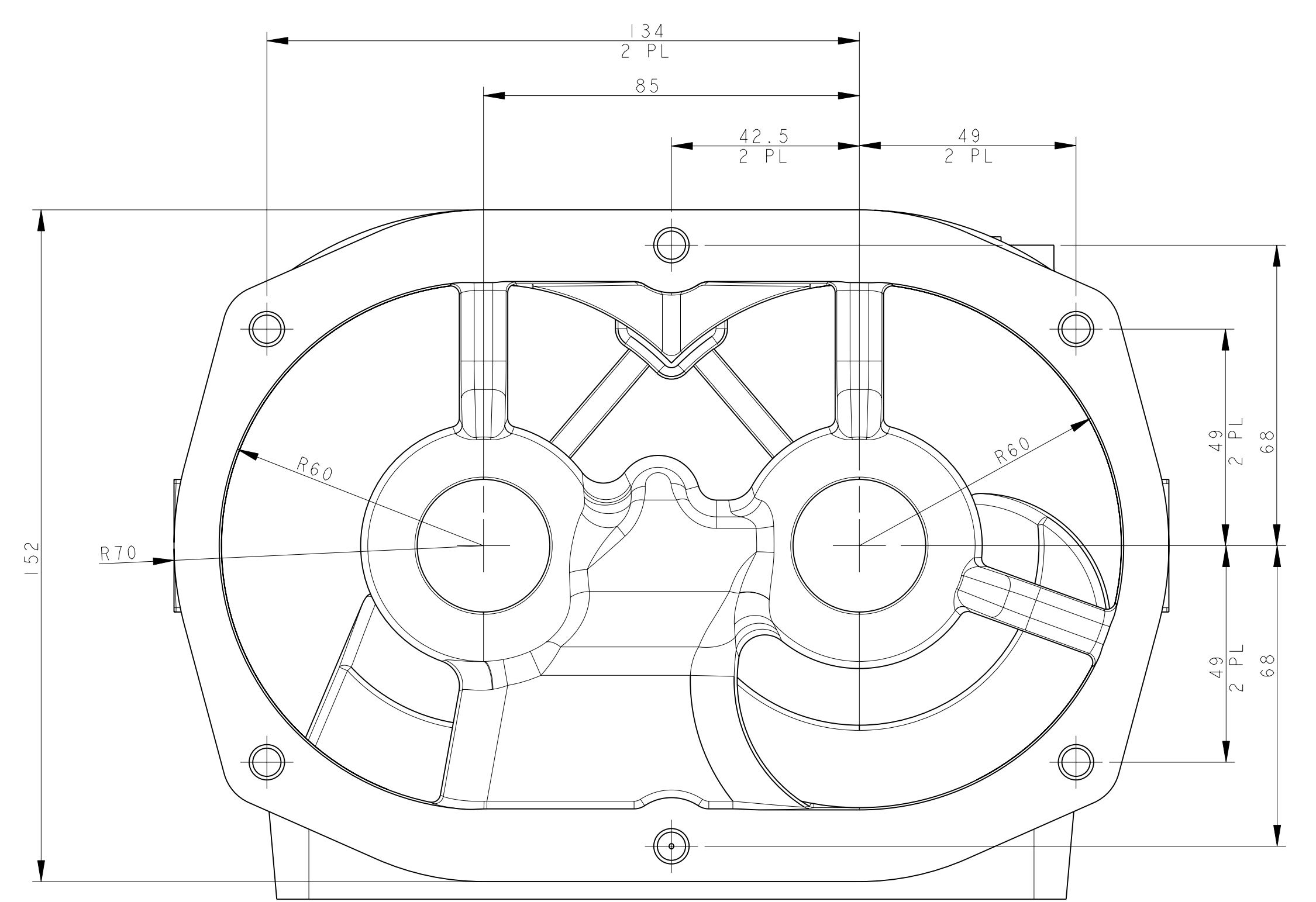
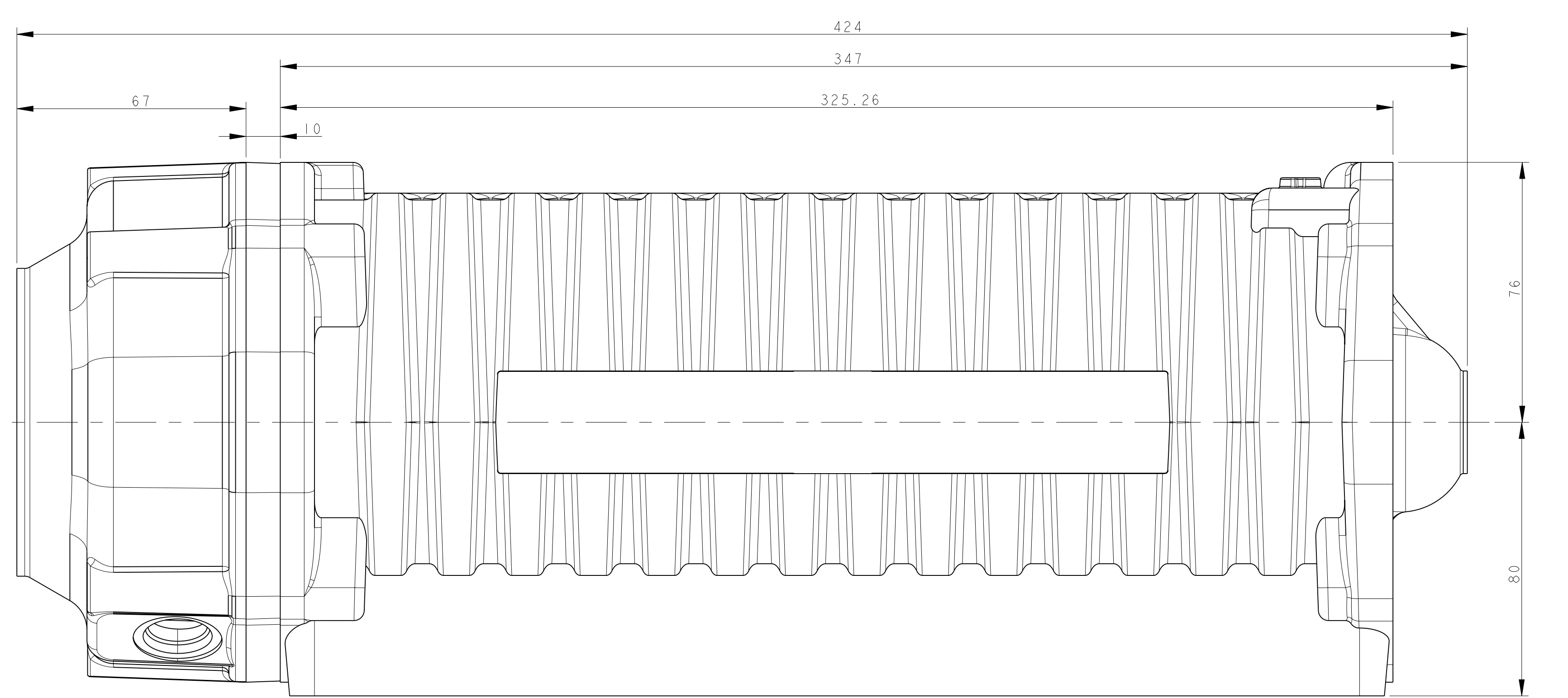
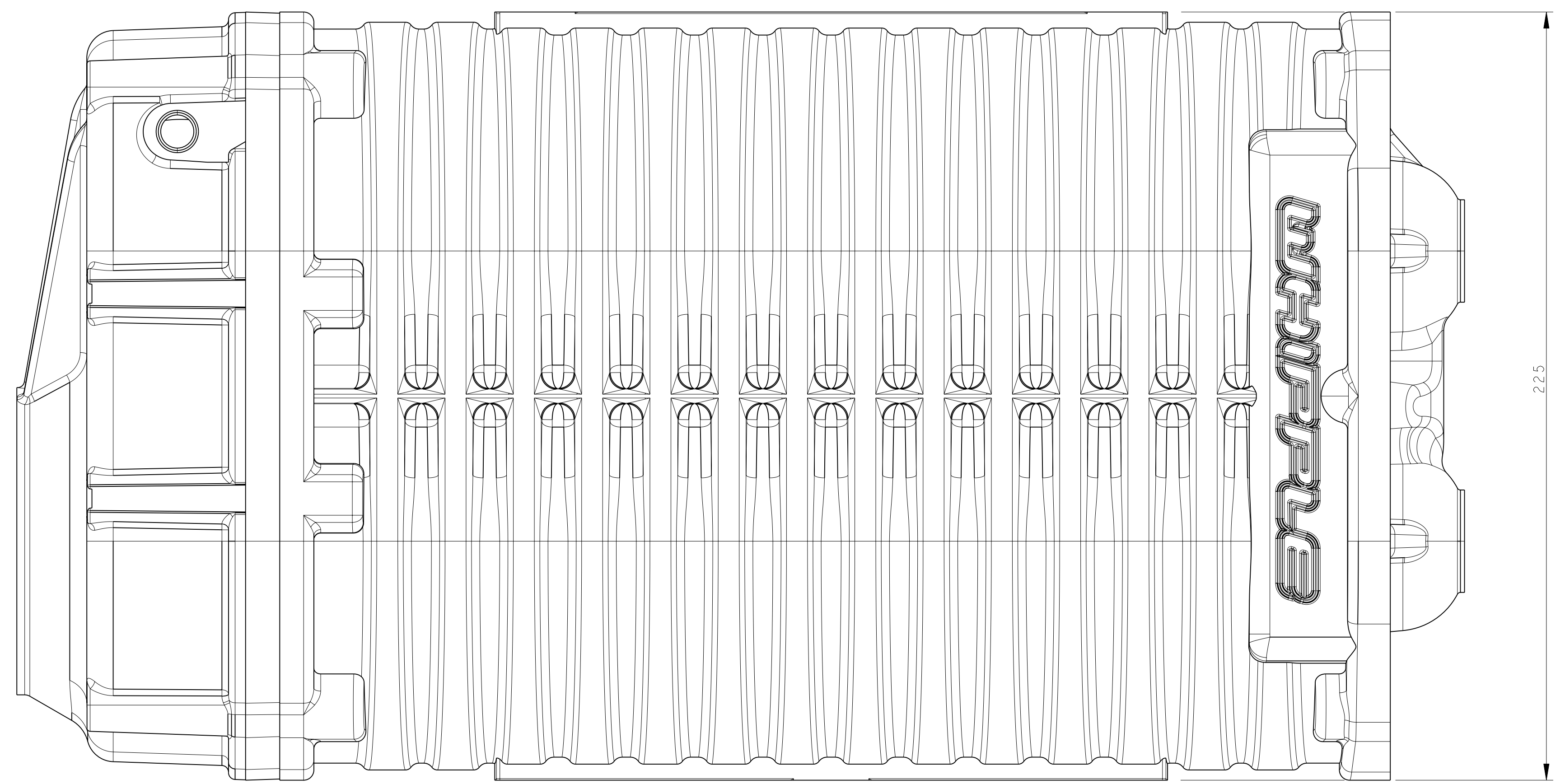

SURFACE FINISH (µm)		TOLERANCE		FINISH		SURFACE PREPARATION		DATE	
Rz	125	±0.1	±0.05						
Rz	125	±0.1	±0.05						

THIRD ANGLE PROJECTION

UNLESS OTHERWISE SPECIFIED:
 1. DIMENSIONS ARE IN MILLIMETERS.
 2. DIMENSIONS IN PARENTHESES ARE FOR INFORMATION.
 3. DIMENSIONS APPLY AFTER FINISHING.
 4. HOLE TOLERANCES ARE AS SHOWN.

OPEN TOLERANCES:
 + 0.15mm -0.05mm H: 0.05
 + 0.20mm -0.10mm H: 0.15
 + 0.30mm -0.15mm H: 0.25
 + 0.50mm -0.25mm H: 0.50
 + 1.00mm -0.50mm H: 1.00

ANGLES: ± 0.5 DEG

FINISH: 1 - 0-100µm

MATERIAL: ALUMINUM
TREATMENT: ANODIZING
SURFACE PREPARATION: AFTER SURFACE PREPARATION

DATE: 08/25/08
DATE: 08/25/08

DESIGNER: HOFMAN
DATE: 08/25/08

TITLE: SUPERCHARGER W245AX
WHIPPLE SUPERCHARGERS

DRAWING NO: WHIPPLE_W245AX
SCALE: 1:0
SHEET: 1 OF 1